

DS-2CC1112/1172/1192P(N)(-A) Box Camera

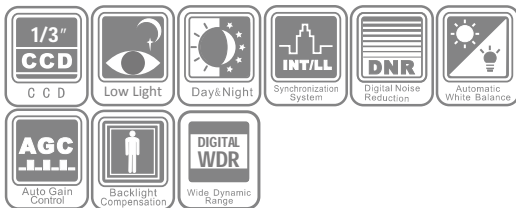

Key features

- 1/3" Sony CCD
- Low illumination
- Digital wide dynamic range
- Digital noise reduction
- Day / night auto switch

Specifications

	DS-2CC1112P(N)(-A)	DS-2CC1172P(N)(-A)	DS-2CC1192P(N)(-A)
Camera			
Image sensor	1/3" SONY Super HAD CCD II	1/3" SONY Super HAD CCD II	1/3" SONY Exview HAD CCD II
Signal system	PAL/NTSC		
Effective pixels	PAL: 752 (H) × 582 (V) NTSC: 768 (H) × 494 (V)	PAL: 752 (H) × 582 (V) NTSC: 768 (H) × 494 (V)	PAL: 976 (H) × 582 (V) NTSC: 976 (H) × 494 (V)
Min. illumination	0.1 Lux @ F1.2, AGC ON	0.1 Lux @ F1.2, AGC ON	0.001 Lux @ F1.2, AGC ON
Shutter time	PAL: 1/50 s to 1/100,000 s NTSC: 1/60 s to 1/100,000 s		
Lens mount	C/CS mount		
Auto iris	DC/Video drive		
Day & night	Electronic		
Horizontal resolution	480 TVL	540 TVL	650 TVL
Synchronization	Internal synchronization (-A series support Internal/Power synchronization)		
Video output	1Vp-p composite output (75 Ω / BNC)		
S/N ratio	More than 52dB	More than 52dB	More than 62 dB
General			
Operating conditions	-10°C ~ 60°C (14°F ~ 140°F) Humidity 90% or less (non-condensing)		
Power supply	12 VDC ± 10% (-A series support 24 VAC ± 10%, 12 VDC ± 10%)		
Power consumption	2W max. (-A series: 3W max.)		
Dimensions	69 x 56 x 113.3 mm (2.72" × 2.20" × 4.46")		
Weight	400g (0.88 lbs)		

Available models

DS-2CC1112P, DS-2CC1112N, DS-2CC1112P-A, DS-2CC1112N-A
 DS-2CC1172P, DS-2CC1172N, DS-2CC1172P-A, DS-2CC1172N-A
 DS-2CC1192P, DS-2CC1192N, DS-2CC1192P-A, DS-2CC1192N-A

Dimensions

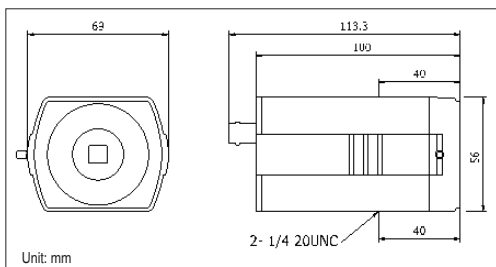

Accessories

